

# YEAR 1 REMOTE LEARNING PLAN

Monday 22<sup>nd</sup> June – Friday 26<sup>th</sup> June 2020



Our theme this week is:

## FANTASY SETTINGS

### KEY VOCABULARY

<b>map</b>	a picture of a particular area of the earth or sky drawn or printed to scale on a flat surface.
<b>symbol</b>	an object or picture that represents something else.
<b>statistics</b>	pieces of data or facts gathered in the form of numbers.
<b>fantasy</b>	a kind of story that is very imaginative and contains different characters, places, or events
<b>graph</b>	uses bars of different lengths to show information.
<b>setting</b>	the surroundings in which an event takes place

### KEEPING IN TOUCH

If you have any questions or queries regarding remote learning tasks, please contact your child's class teacher through the email address below.

We invite you to submit photographs of your children's experiences and photographs of completed paper based tasks to:

[year1@sherwood.lancs.sch.uk](mailto:year1@sherwood.lancs.sch.uk)

### GEOGRAPHY

Last week we had a look at lots of different maps using google earth and digimaps.

[https://www.google.co.uk/intl/en\\_uk/earth/](https://www.google.co.uk/intl/en_uk/earth/)

<https://digimap.edina.ac.uk/>

Username: **PR2 9GA**

Password: **maugre86**

We learned that a map is a birds eye view (a picture from above) using symbols to represent different features.

This week, we would like you to create your own map of your bedroom, garden or kitchen. Think about the shape of the room and the size of the of the objects inside it. Remember you only should draw items which don't move around on your map.

Here are some examples:

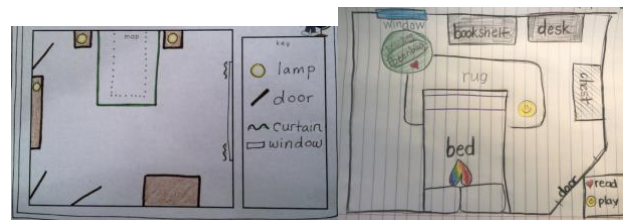

### ART

We all enjoyed the 'Super Happy Magic Forest' last week. Your drawings of Blossom were amazing.

This week we would like you to create you own new character for the story. Use your imagination.

You could create a sixth hero to go on your adventure, or you could draw a Goblin the heroes could meet in the Tower. Or if you feel scary you could think of new creature the heroes meet in the Super Creepy Haunted Forest.

You can use paints, pencil crayons or collage to make your new character as life like a possible. Have fun!!



## ENGLISH CORE LEARNING TASKS

We are really glad you all enjoyed the Super Happy Magic Forest. The maps you created were amazing with lots of detail of the different setting the story takes place. Here is a link for you to re-listen to the story ready for this weeks tasks:

<https://www.youtube.com/watch?v=lxncY2d-n0c>

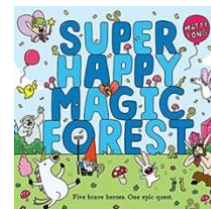

This week, we would like you to creat your own story map of the story. We have done this many times before. Think carefully about the story and where the main events take place in the story. Collect different adjectives and write them around your story map to describe what you might see.

Now its time to be imaginative! We would like you to make a change to the original story. Think carefully about a new setting for the heroes to travel through. It could be anything!! Smartie land, The Candyfloss Palace, The Horrible Stinky Swamp ... get your thinking caps on!

Now with your story map , it is time for you to get writing. You need to retell the story adding your new land in there somewhere. Remember you need to write in sentences beginning with a capital letter and a full stop, use your best handwriting and use lots of WOW words to describe the characters and settings of the story.

## SPELLING/PHONICS FOCUS

### TEACH

Teach reading high frequency words  
thought, any, saw  
Review pronunciation of 'ie' as in pie, lie, tie.  
Teach alternative pronunciation of 'ie' p136.  
Make cards for the following words: chief, field, thief, yield, shield.

### PRACTISE

Ask children to listen to the words, write and sort them into the correct phoneme box:  
yield, belief, chief.

### APPLY

Reading sentences  
The priest is in the field.

Please use this link to Scully's phonics:

[https://central.espresso.co.uk/espresso/primary\\_u/k/subject/module/frontscreen/item63427/grade/def/index.html](https://central.espresso.co.uk/espresso/primary_u/k/subject/module/frontscreen/item63427/grade/def/index.html)

Continue to practise reading and spelling the 100 high frequency words for Year 1.

## MATHS CORE LEARNING TASKS

This week we are continuing to look at statistics. Instead of using sweets to create a bar graph, we are going to create our own pictogram. A pictogram is a graph which shows its data using pictures instead of bars or lines.



Have a go at these pictogram questions so you become familiar with what a pictogram is:

[https://www.softschools.com/math/data\\_analysis/](https://www.softschools.com/math/data_analysis/)

We would like you to look at the television guide. Decide what types of programmes you can watch are they cartoons, films, documentaries, sport or news. Collect the information and then create your own pictogram. Remember one picture represents one of the programs.

Now log onto to Mathletics and have go at the assigned statistics tasks. There is even a bit of a challenge at the end.

## KEY MENTAL MATHS SKILLS TO REHEARSE ORALLY

Try this activity to consolidate our addition work on addition to 10, 15 and 20.



<https://www.topmarks.co.uk/addition/robot-addition>